

Material Features :

- **ELGT82 Series** - Aluminum Alloy Extruded Chassis & Frame with two side plates made of High-pressure die-casting aluminum.
- **ELGT84** - Body & Frame made of High-pressure die-casting Aluminum Alloy
- External electrostatic powder painted over die-cast aluminum parts
- High pure aluminum pre-anodized reflector
- **ELGT86 (LED)** - Body & Frame is made of High-pressure die-casting Aluminum Alloy & adopting high coefficient heat conducting material for heat-releasing
- International top-ranking clip LED light source, quadratic optic non-imaging lens
- Heat-proof silicon gasket, Tempered safety glass.

Applicable Places :

- Illumination of Tunnels, Aisles, Mines, Under Bridges, Under Parking, Bottom high Trestle etc.

IP65 Class I     

ELGT82 - I, II

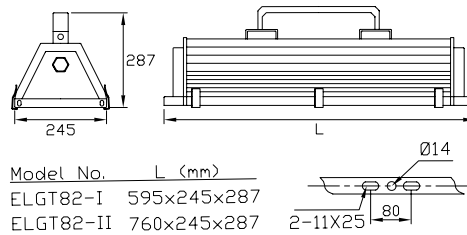

Light Distribution Curve (Cd/1000lm)

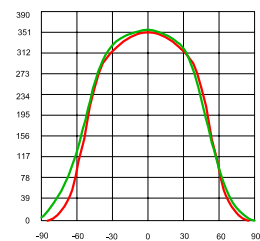

ELGT84

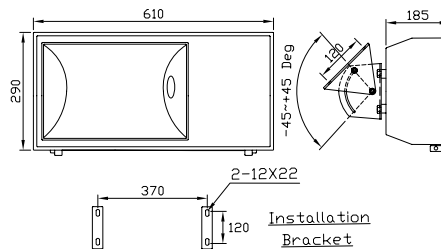

Light Distribution Curve (Cd/1000lm)

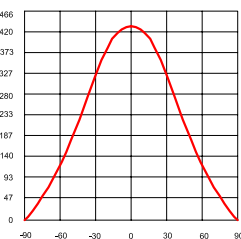

ELGT86 I, II (LED)

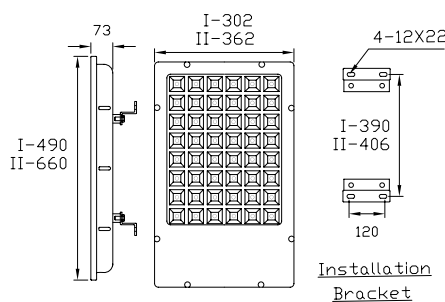

Light Distribution Curve (Cd/1000lm)

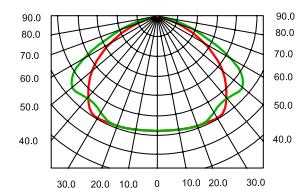

Model No	Light Source	Power W	Power factor pf	Input Voltage V/Hz	Lamp Type	Lamp Life Hr
ELGT82-I	HPS / MH	70~150	>0.85	220~240V / 50-60Hz	E27 / E40	24000 / 12000
ELGT82-II	HPS / MH	250~400	>0.85	220~240V / 50-60Hz	E40	24000 / 12000
ELGT84	HPS / MH	150~400	>0.85	220~240V / 50-60Hz	E40	24000 / 12000
ELGT86-I, II	LED	70, 100, 120 140, 180	>0.85	220~240V / 50-60Hz	56, 70 Pcs LEDs 84, 98 Pcs LEDs	50000